



RBG Series

INFRARED RADIANT HEATERS

Residential



RBG Series Infrared Radiant Heaters

THE ECONOMICAL ALTERNATIVE FOR HARD-TO-HEAT SPACES

- Residential Garages
- Vestibules
- Entryways
- Greenhouses
- Enclosed Patios
- Solariums
- Workshops
- Swimming Pools
- Farm Buildings
- Clubhouses
- Small Businesses
- Auto Garages
- Warehouses
- Print Shops
- Machine Shops
- Small Manufacturing Facilities



HEATS UP TO 5,000 SQ. FT.

Whether you need to heat your garage, workshop, or other hard-to-heat spaces, the Beacon/Morris infrared heater provides both the fuel efficiency of radiant heat and the installation flexibility you need . . . and all at a comfortable price.

COMPACT INFRARED GAS TUBE HEATER

Utilizing a heavy-duty heat exchanger, the Beacon/Morris infrared tube heater provides an efficient source of radiant heat for a wide variety of hard-to-heat spaces.

THE POWER OF RADIANT HEAT

The power of radiant heat, the Beacon/Morris infrared tube heater puts the warmth of the sun inside your building, and it reduces your fuel bills up to 50%! Its radiant heat warms people, concrete floors and objects. The heat is absorbed and re-radiated to warm the entire area through convection. This, combined with the fact that it is powered by gas, adds up to one unbeatable combination. So, consider a very warm and efficient alternative to competitive heaters just blowing hot air. Consider the Beacon/Morris infrared tube heater.

GENERAL FEATURES

- Available in Btu sizes from 25,000 to 45,000
- Compact size - overall length is 9'2" for ease of installation
- Efficiencies range up to 84.5%
- Models for both natural and propane gas
- Installation as low as 8' above floor
- Optional deflector kit for reduced clearances below
- CSA Design Certified



TECHNICAL FEATURES

Vacuum System - Products of combustion are pulled through the combustion chamber for greater safety. . . virtually eliminates the possibility of combustion gases leaking into the heated space.

Solid State Ignition System - Reliable electronic direct spark ignition system with 100% gas safety shut-off control and 30-second prepurge. . . safety and efficiency assurance.

U-Tube Design - Provides uniform emitter tube temperatures and energy distribution on the floor. . . unlike straight tube heaters which are always hotter at the burner end than at the exhaust end.

Warranty - 5-year limited combustion chamber warranty.

Other Features - Heavy-duty combustion chamber, aluminum reflectors with 97% reflectivity rating, diaphragm safety switch for proof of venting, and system indicator lights.

TECHNICAL SPECIFICATIONS

MODEL	BTU/HR INPUT	HEAT EXCHANGER LENGTH	TOTAL HEATER LENGTH	FLUE RESTRICTOR PLATE I.D. & PART NO.		ORIFICE SIZE		MINIMUM* MOUNTING HEIGHT	
						NATURAL GAS	PROPANE GAS	HORIZONTAL	45° ANGLE
RBG 025	25,000	16'	9'-3"	7/8"	42741120	#42 (0.094)	#52 (0.064)	8'	8'
RBG 035	35,000			1"	42741041	#35 (0.110)	1.75mm (0.069)	8'	8'
RBG 045	45,000			1-1/8"	42741031	1/8" (0.125)	5/64" (0.078)	8'	8'

* MOUNT HEATERS AS HIGH AS POSSIBLE. Minimums are shown as a guideline for human comfort and uniform energy distribution for complete building heating applications. Consult your representative for the particulars of your installation requirements.

TYPE GAS	GAS PIPE CONNECTION	TUBE DIAMETER	FLUE CONNECTION	FRESH AIR CONNECTION	ELECTRICAL SUPPLY	CURRENT RATING
Natural or Propane	1/2" MPT (Male)	3"	4" Round	4" Round	120 Volt, 60Hz, 1 Phase	2.6 Amp

FUSE RATING	IGNITION SYSTEM (DIRECT SPARK)
Spark Module: 2 Amp 250V (for 24V Circuit)	30 second pre-purge period

DIMENSIONS

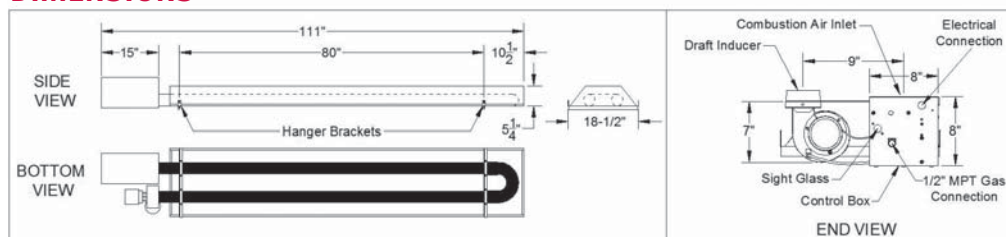

MINIMUM CLEARANCES TO COMBUSTIBLES

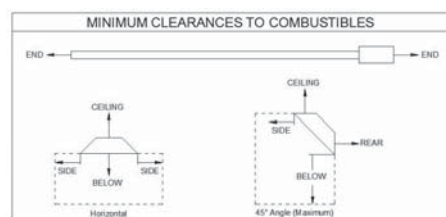

MODEL	MINIMUM CLEARANCES TO COMBUSTIBLES					
	MOUNTED HORIZONTALLY			ANGLE MOUNTED AT 45°		
	SIDES	CEILING ¹	BELOW ²	ENDS	FRONT	REAR
RBG 025	8"	4"	41" *	8"	30"	4"
RBG 035, 045	12"	4"	57" **	8"	40"	4"

¹ The clearance is 12" when installed in an UNVENTED configuration in industrial and commercial installations.

² IN CANADA, clearances below the heater are: -RBG 025: 36" (27" with deflector)
-RBG 035, 045: 48" (36" with deflector)

* The clearance is 33" with deflector.

** The clearance is 42" with deflector / 30" side clearance with deflector.

MODEL SELECTION GUIDELINES

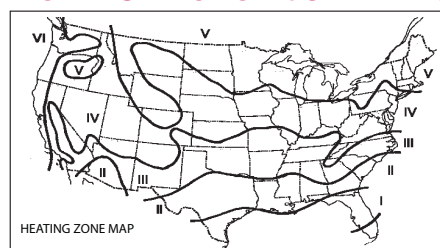

Properly selected heaters will provide the most efficient operation for your installation. The models recommended are selected for a 22' x 28' two-car or a 26' x 32' three-car insulated garage. Select the model number corresponding to the geographic location in which the heater will be installed. Model size is determined by garage heat loss. Please consult your distributor to determine the heat loss for your particular application.

ZONE	MODEL
I and II	RBG 25
III and IV	RBG 35
IV and V	RBG 45

Warranty

INFRARED HEATER

Beacon/Morris (“the Manufacturer”) warrants to the original owner at the original installation site that the Beacon/Morris Model Infrared Heater will be free from defects in material and workmanship for one (1) year from the date of shipment from the factory. If upon examination by the Manufacturer the Product is shown to have a defect in material or workmanship during the warranty period, the Manufacturer will repair or replace, at its option, that part of the product which is shown to be defective.

Extended warranty:

In addition to the warranty stated above the following models will have:

- RBG – Tubes shall be free from defects in material and workmanship for five (5) years from the date of shipment from the factory. Burner Head shall be free from defects in material and workmanship for ten (10) years from the date of shipment from the factory.

This limited warranty does not apply:

- a) If the Product has been subjected to misuse or neglect, has been accidentally or intentionally damaged, has not been installed, maintained or operated in accordance with the furnished written instructions, or has been altered or modified in any way by an unauthorized person.
- b) To any expenses, including labor or material, incurred during removal or reinstallation of the Product.
- c) To any damage due to corrosion by chemicals, including halogenated hydrocarbons, precipitated in the air.
- d) To any workmanship of the installer of the Product.

This limited warranty is conditional upon:

- a) Advising the installing contractor, who will in turn notify the distributor or manufacturer.
- b) Shipment to the Manufacturer of that part of the Product thought to be defective. Goods can only be returned with prior written approval of the Manufacturer. All returns must be freight prepaid.
- c) Determination in the reasonable opinion of the Manufacturer that there exists a defect in material or workmanship.

Repair or replacement of any part under this Limited Warranty shall not extend the duration of the warranty with respect to such repaired or replaced part beyond the stated warranty period.

THIS LIMITED WARRANTY IS IN LIEU OF ALL OTHER WARRANTIES, EITHER EXPRESS OR IMPLIED, AND ALL SUCH OTHER WARRANTIES, INCLUDING WITHOUT LIMITATION IMPLIED WARRANTIES OF MERCHANTABILITY OR FITNESS FOR A PARTICULAR PURPOSE, ARE HEREBY DISCLAIMED AND EXCLUDED FROM THIS LIMITED WARRANTY. IN NO EVENT SHALL THE MANUFACTURER BE LIABLE IN ANY WAY FOR ANY CONSEQUENTIAL, SPECIAL, OR INCIDENTAL DAMAGES OF ANY NATURE WHATSOEVER, OR FOR ANY AMOUNTS IN EXCESS OF THE SELLING PRICE OF THE PRODUCT OR ANY PARTS THEREOF FOUND TO BE DEFECTIVE. THIS LIMITED WARRANTY GIVES THE ORIGINAL OWNER OF THE PRODUCT SPECIFIC LEGAL RIGHTS. YOU MAY ALSO HAVE OTHER RIGHTS WHICH MAY VARY BY EACH JURISDICTION.



260 NORTH ELM STREET, WESTFIELD, MA 01085 • TEL: (413) 562-5423 • FAX: (413) 572-3764

7555 TRANMERE DRIVE, MISSISSAUGA, ONTARIO L5S 1L4 CANADA • TEL: (905) 670-5888 • FAX: (905) 670-5782

