

ARROW

EXTRUDED ALUMINUM LOUVERS 6" DEEP

NOA NO. 08-1224.03

TYPE EA-64

DRAIN BLADE-STATIONARY-CHANNEL TYPE
WITHSTANDS DESIGN PRESSURE UP TO ±180 PSF

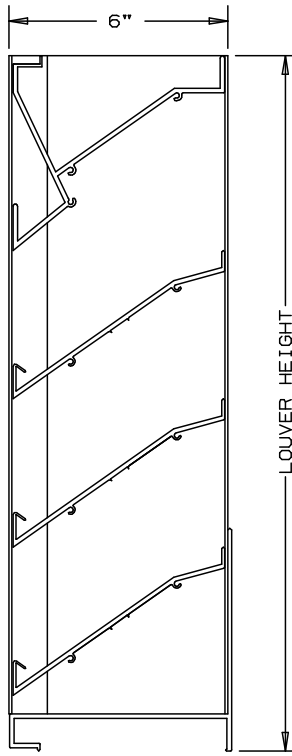

NOT TO SCALE

1 1/2"

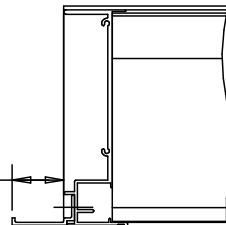

OPTIONAL FLANGE
FRAME SHOWN

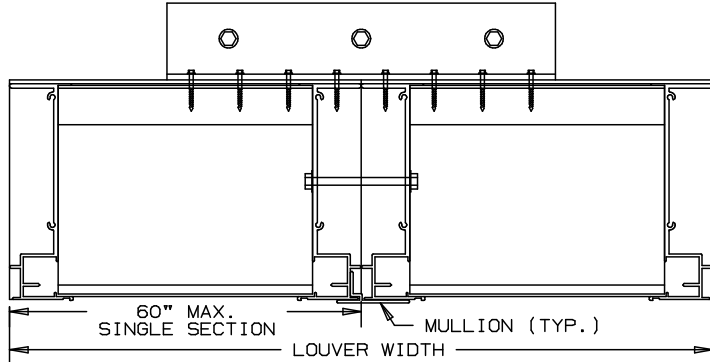

SPECIFICATIONS

FRAME: EXTRUDED ALUMINUM CHANNEL FRAME .125" THK., OF 6063-T6 ALLOY OF WELDED CONSTRUCTION.
 BLADE: EXTRUDED ALUMINUM .081" THK. OF 6063-T5 ALLOY MECHANICAL FASTENING CONSTRUCTION.
 FACE OF LOUVER: FULL WIDTH SILL WITH HEAD AND BLADES CONTAINED WITHIN JAMBS. APPROXIMATE BLADE CENTERS 4".
 SCREEN: (WHEN INDICATED, IN A REMOVABLE FRAME)
 BIRD SCREEN - 1/2" FLATTENED ALUMINUM, .051" THK.
 OR - 1/2" SQ. MESH INTERMEDIATE DOUBLE-CRIMPED ALUMINUM WIRE, .063" DIA.
 OR - 18/16 MESH, .011" DIA. ALUMINUM WIRE INSECT SCREEN.

FINISH: _____

MINIMUM PANEL SIZE: 12" x 12"
 MAXIMUM PANEL SIZE: 96" x 96"

LOUVER PERFORMANCE STATEMENT

PASSED MIAMI-DADE COUNTY FLORIDA TEST PROTOCOLS TAS (PA) 201, TAS (PA) 202, AND TAS (PA) 203
 PANELS OVER 48" WIDE WILL HAVE A 2"x2"x1/4" VERTICAL INTERIOR BLADE SUPPORT ANGLE AT APPROXIMATE CENTER OF PANELS.
 THE ARROW MODEL EA-64 SHALL BE FABRICATED TO PROVIDE A MINIMUM OF (58%), 9.24 SQUARE FEET OF FREE AREA FOR A 48"x48" SIZE LOUVER, AND BEAR THE AMCA CERTIFIED RATING PROGRAM SEAL FOR AIR PERFORMANCE AND WATER PENETRATION. THE RATING SHALL SHOW A BEGINNING POINT OF WATER PENETRATION AT .01 OUNCES PER SQUARE FOOT OF FREE AREA TO BE ABOVE 1250 FEET PER MINUTE (11,550) CUBIC FEET PER MINUTE WITH .10 INCHES WATER GAUGE PRESSURE DROP AT 850 FPM FOR AIR INTAKE.

FOR CERTIFIED RATINGS
 AUTHORIZED BY AMCA
 -SEE REVERSE SIDE

NOMINAL DEDUCTIONS WILL BE MADE TO THE OPENING SIZE GIVEN.

ITEM	QTY.	WIDTH	HEIGHT	WIDTH	HEIGHT	MULL	TYPE	LOC	SCREENS	UNION MADE
		OPENING SIZE		LOUVER SIZE						

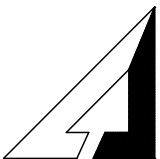
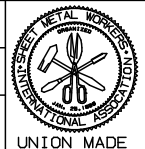

ARROW UNITED INDUSTRIES
 A DIVISION OF MESTEK, INC.

450 RIVERSIDE DRIVE
 WYALUSING, PA 18853

TEL: (570) 746-1888 FAX: (570) 746-9286
 WEB ADDRESS: WWW.ARROWUNITED.COM

AGENT: _____

ARCH./ENG.:
CONTR.:
PROJECT:
EDR: ECN: JOB:
DATE: DWN.: DWG.:

LOUVER MODEL EA-64 DRAIN BLADE EXTRUDED ALUMINUM - STATIONARY

PERFORMANCE DATA

EXCELLENT WEATHER PROTECTION WITH LITTLE PRESSURE LOSS.

TESTS OF A 48" X 48" SAMPLE ACCORDING TO AMCA STANDARD 500-L SHOWS LOW WATER PENETRATION. TESTS SHOW THE BEGINNING POINT OF WATER PENETRATION IS ABOVE 1250 FPM THROUGH THE FREE AREA OF THE LOUVER, WITH LESS THAN .14" W.G. PRESSURE DROP AT 1000 FPM (INTAKE).

RATINGS DO NOT INCLUDE THE EFFECT OF BIRDSCREEN.

PRESSURE DROP

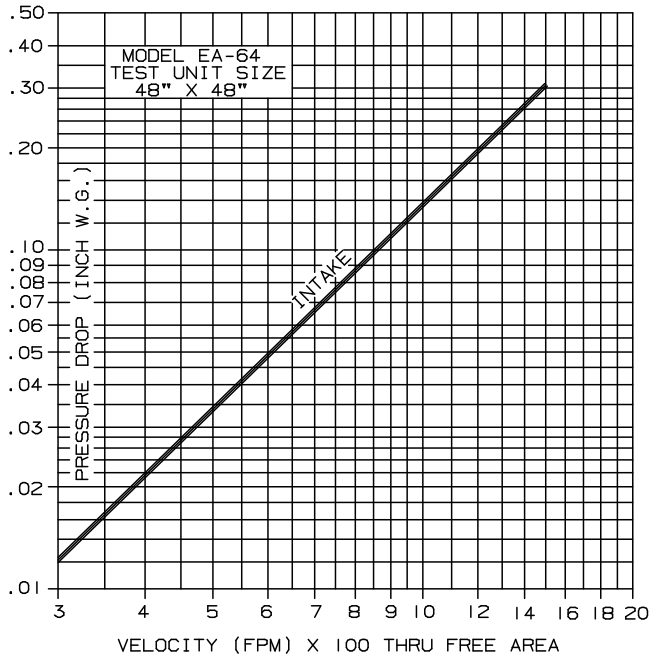

WATER PENETRATION

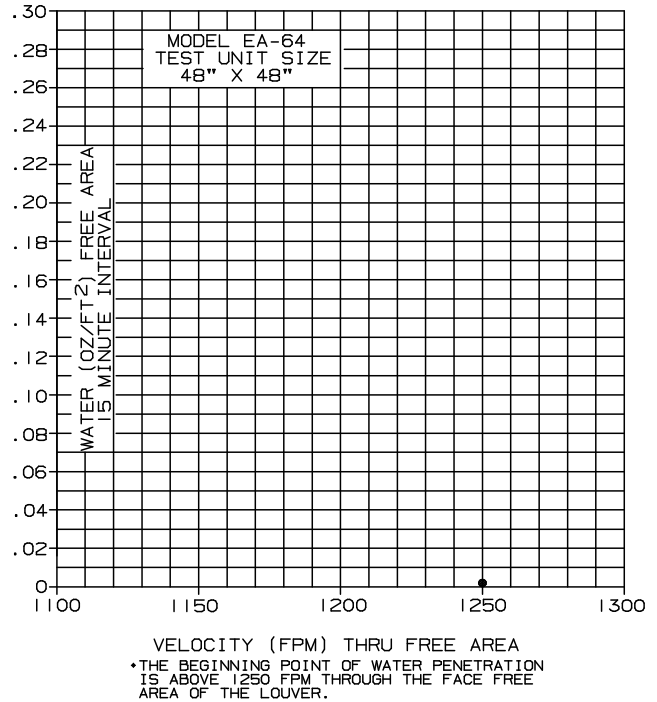

*AMCA STANDARD 500 LIMITS TESTING OF WATER PENETRATION TO EITHER A MAXIMUM VELOCITY OF 1250 FPM OR 2.5 OUNCES OF WATER PER SQUARE FOOT OF LOUVER FREE AREA.

FREE AREA

HEIGHT	FREE AREA (SQ. FT.)							
	WIDTH							
	12"	24"	36"	48"	60"	72"	84"	96"
12"	.18	.43	.69	.94	1.16	1.42	1.67	1.93
24"	.69	1.70	2.70	3.71	4.59	5.59	6.60	7.60
36"	1.21	2.96	4.72	6.47	8.01	9.76	11.52	13.27
48"	1.72	4.23	6.73	9.24	11.43	13.93	16.44	18.94
60"	2.24	5.49	8.75	12.00	14.85	18.11	21.36	24.62
72"	2.75	6.76	10.72	14.77	18.27	22.28	26.28	30.29
84"	3.27	8.02	12.78	17.53	21.69	26.45	31.20	35.96
96"	3.78	9.29	14.79	20.30	25.12	30.62	36.13	41.63

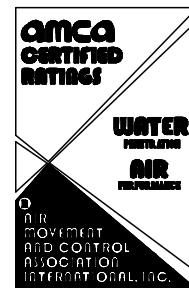

ARROW UNITED CERTIFIES THAT THE MODEL EA-64 SHOWN HEREIN IS LICENSED TO BEAR THE AMCA SEAL. THE RATINGS SHOWN ARE BASED ON TESTS AND PROCEDURES PERFORMED IN ACCORDANCE WITH THE AMCA PUBLICATION 511 AND COMPLY WITH THE REQUIREMENTS OF THE AMCA CERTIFIED RATINGS PROGRAM. THE AMCA CERTIFIED RATINGS SEAL APPLIES TO AIR PERFORMANCE AND WATER PENETRATION RATINGS ONLY.

ARROW SLEEVE OR SLEEVE AND DAMPER HURRICANE LOUVER

TYPE EA-64

NOA NO. 08-1224.03

THIS DAMPER/LOUVER COMBINATION PROVIDES A WATER RESISTANT SYSTEM. THE EA-64 (NOA 08-1224.03) DADE COUNTY APPROVED LOUVER REQUIRES THE AFD-20 DAMPER INSTALLED WITH THE LOUVER PANEL TO MAKE IT A WATER RESISTANT SYSTEM.

PANEL SIZE

MODEL	MAX. SINGLE PANEL
EA-64	48"W x 96"H
AFD-20	48"W x 96"H

NOTES:

1. NUMBER OF DAMPERS BEHIND A LOUVER PANEL IS UNLIMITED.
2. DAMPER MULLIONS/SEAMS DO NOT HAVE TO ALIGN WITH LOUVER PANEL SEAMS.
3. ARCHITECTURAL LOUVERS ALSO APPLY.

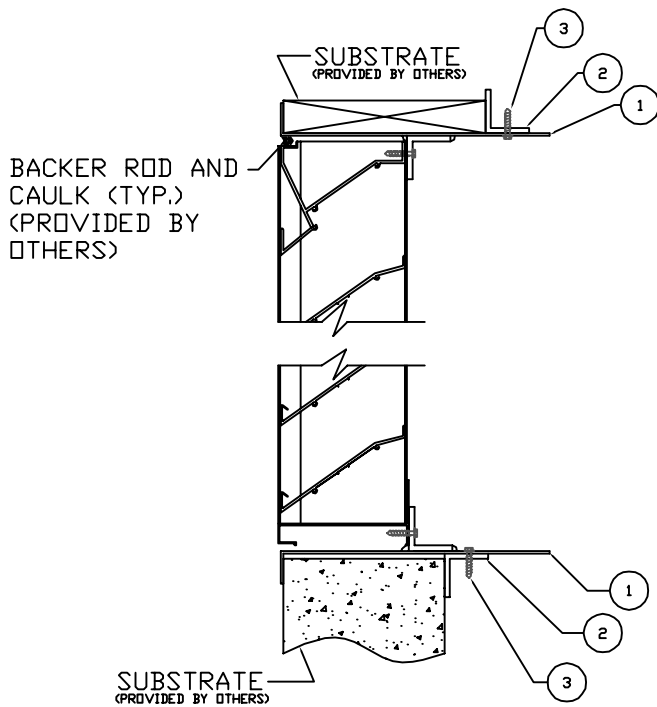

BACKER ROD AND
CAULK (TYP.)
(PROVIDED BY
OTHERS)

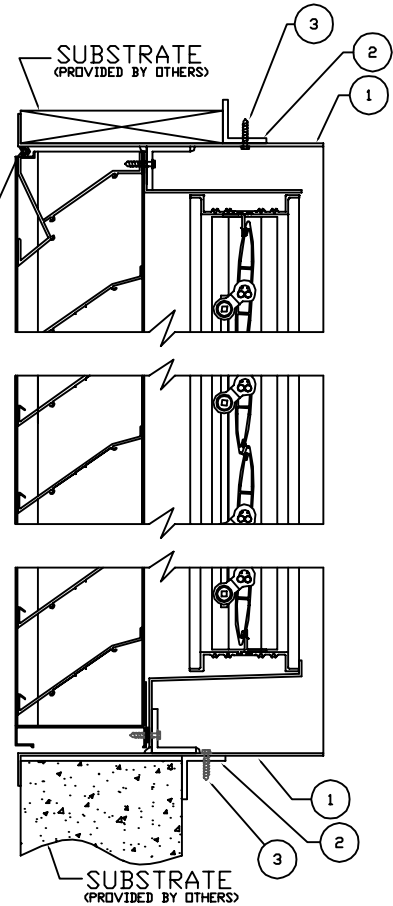

ALL FASTENERS MUST BE A307 PLATED STEEL OR 304 STAINLESS STEEL

B	#14 x 1 1/4" TEK SCREW
C	#10 x 2" WOOD SCREW
D	#10 x 2" LONG SHEET METAL SCREW
E	1/4" x 1 3/4" LONG TAPCON SCREW
F	1/2" x 1 3/4" BOLT
G	2" x 2" 6063-T5 EXTRUDED ALUMINUM ANGLE
H	2" x 4" 6063-T5 EXTRUDED ALUMINUM ANGLE
I	.125" ALUMINUM SLEEVE

	WOOD	CONCRETE	STEEL
1	I	I	I
2	G/H	G/H	G/H
3	D	D	D

ARROW UNITED INDUSTRIES
A DIVISION OF MESTEK, INC.
450 RIVERSIDE DRIVE
WYALUSING, PA 18853
TEL:(570)746-1888 FAX:(570)746-9286

AGENT: _____

ARCH./ENG.:

CONTR.:

PROJECT:

EDR:

ECN:

JOB:

DATE:

DWN:

DWG.:

ARROW SLEEVE OR SLEEVE AND DAMPER HURRICANE LOUVER

NOA NO. 08-1224.03

TYPE EA-64

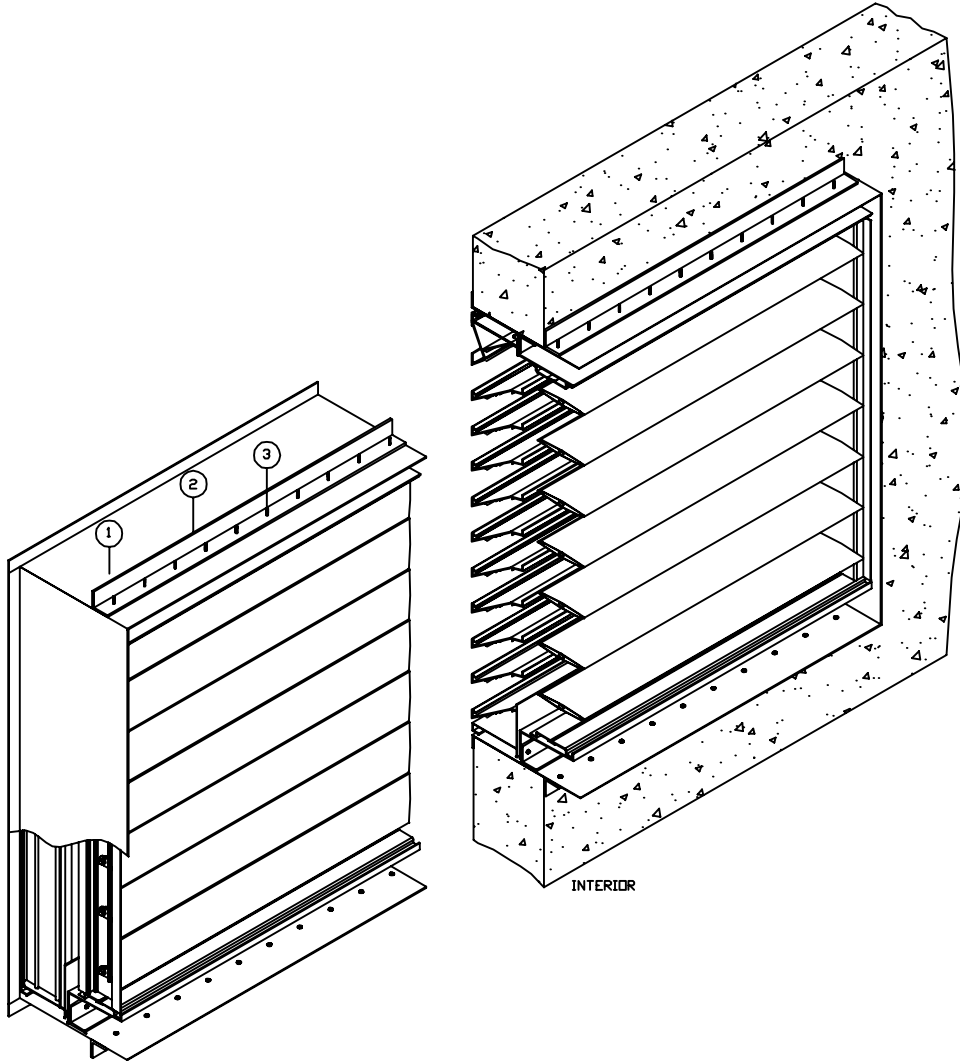

SUBSTRATE REMOVED FOR CLARITY

INTERIOR

	WOOD	CONCRETE	STEEL
1	I	I	I
2	G	G	G
3	D	D	D

ALL FASTENERS MUST BE A307 PLATED STEEL OR 304 STAINLESS STEEL	
D	#10 x 2" LONG SHEET METAL SCREW
G	2" x 2" 6063-T5 EXTRUDED ALUMINUM ANGLE
I	.125" ALUMINUM SLEEVE

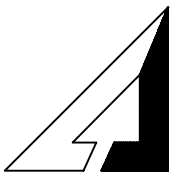

ARROW UNITED INDUSTRIES
A DIVISION OF MESTEK, INC.

450 RIVERSIDE DRIVE
WYALUSING, PA 18853

TEL:(570)746-1888 FAX:(570)746-9286